

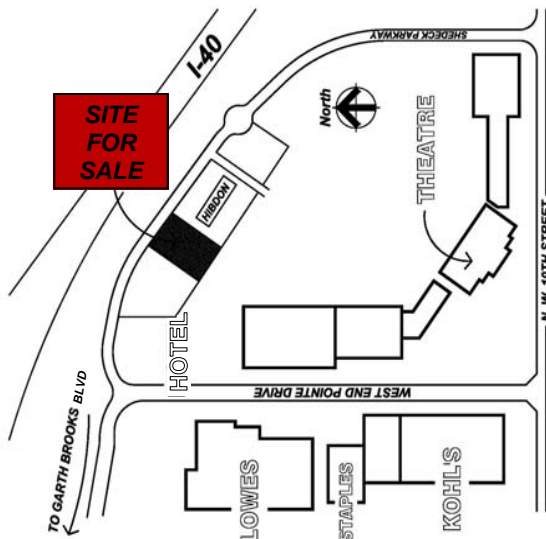

EMBREE GROUP

NATIONAL DEVELOPERS

Build-to-Suit or Ground Lease Opportunity in Yukon, Oklahoma



Lot 3 of the West End Pointe Lifestyle Center Now Available

- Part of Lifestyle Center Including Tenant Anchors: Lowe's, Staples, Kohl's & Dickinson Movie Theater
- .082 AC/ 35,853 SF. Lot
- Zoned C3 Commercial
- Great Interstate Visibility
- All Utilities Available

For More Information, Contact:

ROCKY HARDIN

512.819.4709

rhardin@embreegroup.com • www.embreegroup.com

Call for Current Price & Cap Rate!

DEMOGRAPHICS

POPULATION	1 MILE	3 MILE	5 MILE
2011 Forecast	4,367	32,046	47,118
2006 Update	4,100	30,151	44,269
2000 Census	4,093	27,937	40,411
2006 Average Median Family Household Income	\$60,308	\$63,255	\$66,089

- Yukon, Oklahoma, a suburban city in Canadian County, is part of the Oklahoma City Metropolitan Statistical Area, situated just west of Oklahoma City. Seven Counties comprise the OKCM, which has a population totaling approximately 1,200,00 residents.

- City of Yukon Total Population 56,700
- Canadian County boasts the highest median income county in the state of Oklahoma.
- Total Trade Area (2006 estimates) for surrounding areas:

Canadian County	101,335	West Oklahoma City	75,390
Mustang	16,975	El Reno	16,222

- The average new home building permit in 2005 was issued for \$205,000, compared with \$140,000 just 5 years ago in 2000.
- Yukon is strategically located along Interstate 40 which connects it to Oklahoma City (12 miles east) and the John Kilpatrick Turnpike, a 20-mile connection that links Yukon to the fastest growing area of north OKC and Edmond, OK.

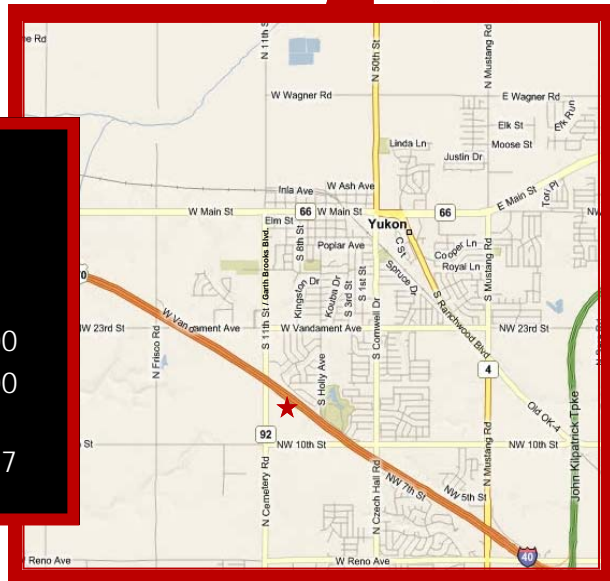

TRAFFIC COUNTS

2006 Average Daily Counts (cars/day)

I-40 east of Garth Brooks Blvd.	64,400
I-40 west of Garth Brooks Blvd.	69,700
Garth Brooks Blvd. north of Health Center Parkway	29,527

Embee Asset Group, Inc. and various officers, employees and agents thereof are licensed Texas Real Estate Brokers or Sales Agents representing the Seller of this property. The information above is from sources deemed reliable; however, we have not verified it and make no guaranties, warranties or representations about such information. You should not rely on any of this information without independently confirming its accuracy and completeness. Any projections, opinions, assumptions or estimates are for example only and do not necessarily represent the current or future performance of the property. You and your advisors should conduct a careful, thorough and independent investigation of the property and the tax and other financial matters to determine to your satisfaction the suitability of the property for your needs. The property is offered without regard to race, color, creed, familial status, national origin, religion, or handicap status.